

MAUMEE RIVER



PRODUCED BY
CITY OF FORT WAYNE
G.I.S. DEPARTMENT

NOTICE: THE INFORMATION
DEPICTED ON THIS MAP
CONCERNING LOCATION,
TYPE, AND SIZE OF STREET
INFRASTRUCTURE IS NOT
GUARANTEED TO BE
ACCURATE OR ALL
INCLUSIVE. INFORMATION
SHOWN WAS OBTAINED
FROM AVAILABLE RECORDS.
FIELD INVESTIGATION
SHOULD BE CONDUCTED TO
DETERMINE ACCURACY.

CITY OF FORT WAYNE
STREET ENGINEERING
CITIZENS SQUARE
200 EAST BERRY STREET
FORT WAYNE, IN 46802



SE 1/4 SEC. 6
TOWNSHIP 30 N, RANGE 13 E
ADAMS TWP, ALLEN CO.

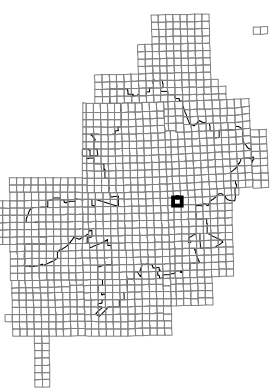

MAP NO.
Q06
12/8/2015

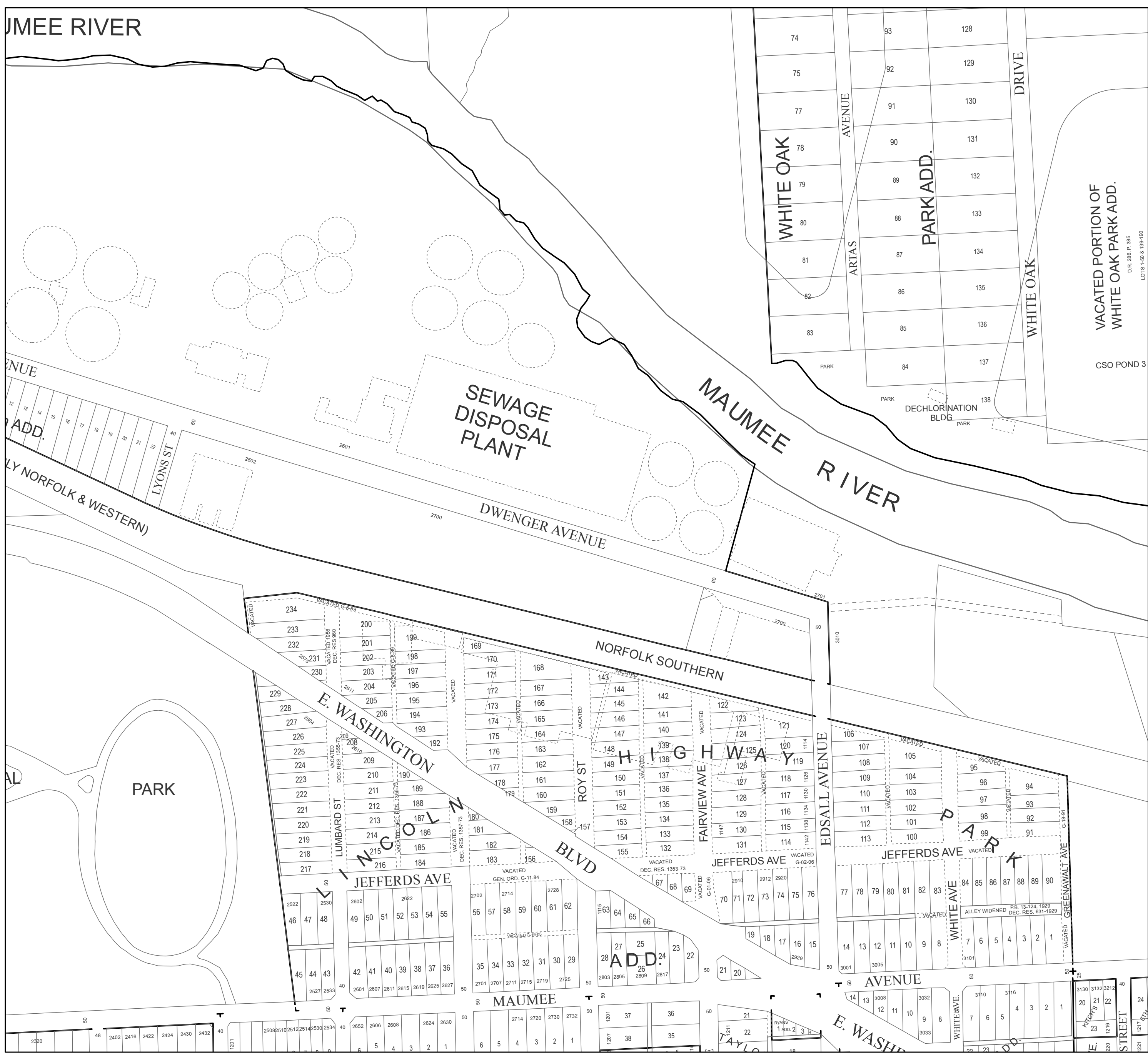

VACATED PORTION OF
WHITE OAK PARK ADD.
D.R. 286, P. 385
LOTS 1-50 & 135-190

CSO POND 3

WHITE OAK

PARK ADD.

DRIVE

ARTAS AVENUE

WHITE OAK

DECHLORINATION BLDG

MAUMEE RIVER

SEWAGE DISPOSAL PLANT

DWENGER AVENUE

NORFOLK SOUTHERN

E. WASHINGTON

BLVD

HIGHWAY

ROY ST

FAIRVIEW AVE

JEFFERDS AVE

EDSALL AVENUE

JEFFERDS AVE

WHITE AVE

AVENUE

E. WASH

WHITE AVE.

GREENWALT AVE

AVENUE

PARK ADD.

LYONS ST

PARK

JEFFERDS AVE

MAUMEE

ADD.

2320 48 2402 2416 2422 2424 2430 2432

2508 2510 2512 2514 2530 2534

2714 2720 2730 2732

1201 37 36 1207 38 35

14 13 3008 12 11 10 9 8 3110 3116

3130 3132 3212 40 20 21 22 23 24