



PRODUCED BY  
CITY OF FORT WAYNE  
G.I.S. DEPARTMENT

**LEGEND**

- SEWER / COMBO MANHOLE
- STORM MANHOLE
- ⊗ RETIRED MANHOLE
- CATCH BASIN
- △ INLET
- CLEANOUT
- ⊕ DISCHARGE
- ⊠ GATE VALVE
- ⌒ HEADWALL
- ⌒ HEADWALL w/FLAPGATE
- ⊥ BULKHEAD / PLUG
- PS PUMP STATION
- RI REGULATOR
- ⊕ VALVE PIT
- ⊕ AIR RELEASE VALVE
- ▼ DUCKBILL FLAPGATE

- SANITARY PIPE
- STORM PIPE
- COMBINED PIPE
- PRESSURIZED MAIN
- PRIVATE MAIN
- RETIRED MAIN
- R22 176 STRUCTURE ID
- 12345 PROJECT ID

NOTICE: THE INFORMATION DEPICTED ON THIS MAP CONCERNING LOCATION, TYPE, SIZE AND MATERIAL OF UNDERGROUND UTILITIES IS NOT GUARANTEED TO BE ACCURATE OR ALL INCLUSIVE. INFORMATION SHOWN WAS OBTAINED FROM AVAILABLE RECORDS. FIELD INVESTIGATION SHOULD BE CONDUCTED TO DETERMINE ACCURACY.

**CITY OF FORT WAYNE**  
**CITY UTILITIES**  
 CITIZENS SQUARE  
 200 E. BERRY STREET  
 FORT WAYNE, IN 46802

SE 1/4 SEC. 27  
 TOWNSHIP 31 N, RANGE 12 E  
 WASHINGTON TWP, ALLEN CO.  
 MAP SCALE : 1" = 200'

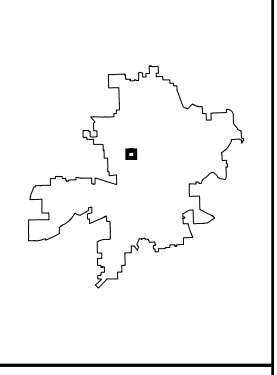

MAP NO.  
**K22**  
 6/29/2023

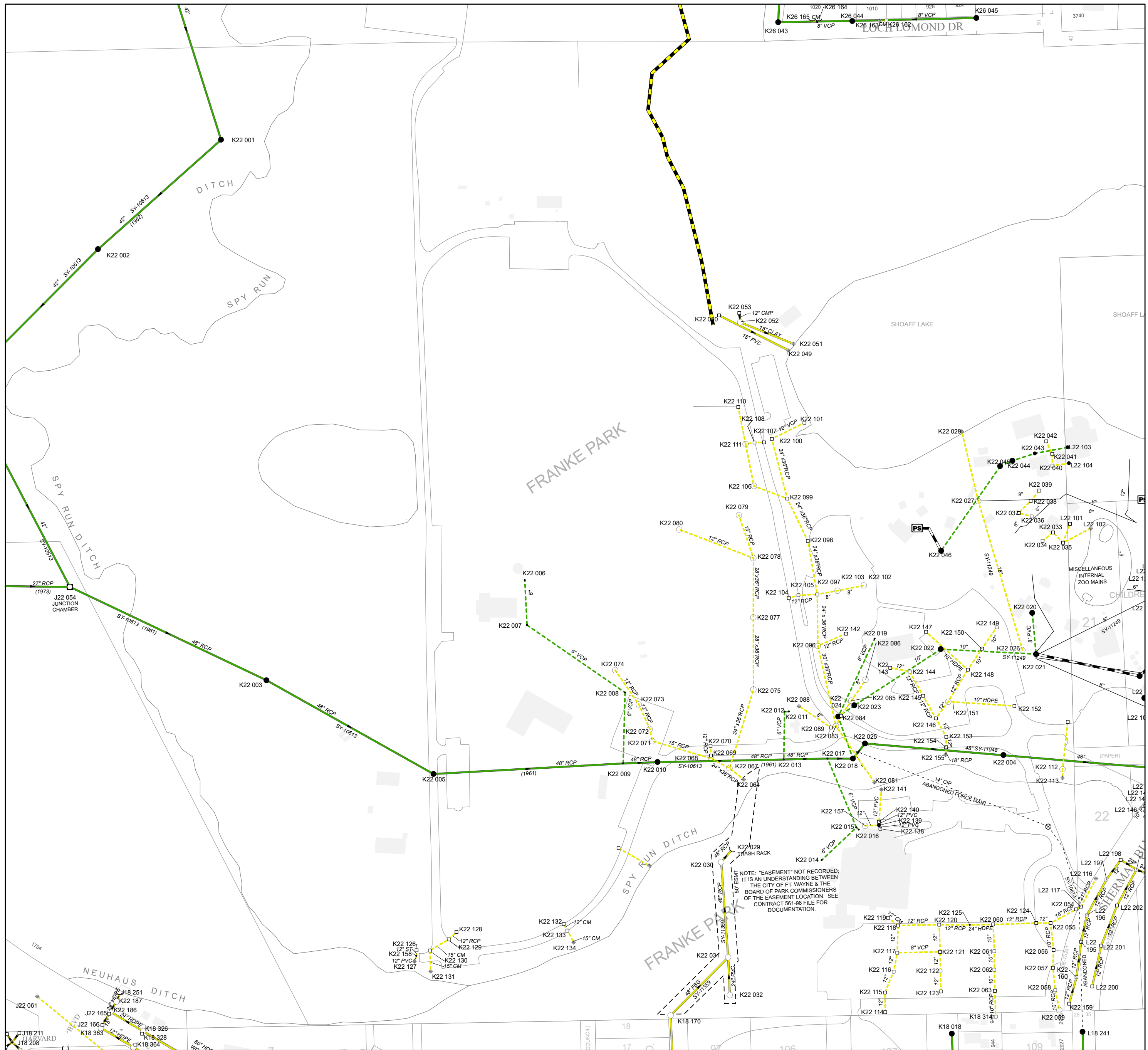

NOTE: "EASEMENT" NOT RECORDED. IT IS AN UNDERSTANDING BETWEEN THE CITY OF FT. WAYNE & THE BOARD OF PARK COMMISSIONERS OF THE EASEMENT LOCATION. SEE CONTRACT 361-88 FILE FOR DOCUMENTATION.