



PRODUCED BY  
CITY OF FORT WAYNE  
G.I.S. DEPARTMENT

**LEGEND**

- SEWER / COMBO MANHOLE
- STORM MANHOLE
- ⊗ RETIRED MANHOLE
- CATCH BASIN
- △ INLET
- CLEANOUT
- ⊕ DISCHARGE
- ⊠ GATE VALVE
- ⌒ HEADWALL
- ⌒ HEADWALL W/FLAPGATE
- ⊥ BULKHEAD / PLUG
- PS PUMP STATION
- RI REGULATOR
- ⊖ VALVE PIT
- ⊕ AIR RELEASE VALVE
- ▼ DUCKBILL FLAPGATE

- SANITARY PIPE
- STORM PIPE
- COMBINED PIPE
- PRESSURIZED MAIN
- PRIVATE MAIN
- RETIRED MAIN

R22 176 STRUCTURE ID  
12345 PROJECT ID

NOTICE: THE INFORMATION DEPICTED ON THIS MAP CONCERNING LOCATION, TYPE, SIZE AND MATERIAL OF UNDERGROUND UTILITIES IS NOT GUARANTEED TO BE ACCURATE OR ALL INCLUSIVE. INFORMATION SHOWN WAS OBTAINED FROM AVAILABLE RECORDS. FIELD INVESTIGATION SHOULD BE CONDUCTED TO DETERMINE ACCURACY.

**CITY OF FORT WAYNE**  
**CITY UTILITIES**  
 CITIZENS SQUARE  
 200 E. BERRY STREET  
 FORT WAYNE, IN 46802

SW 1/4 SEC. 30  
 TOWNSHIP 32 N, RANGE 12 E  
 PERRY TWP, ALLEN CO.  
 MAP SCALE : 1" = 200'

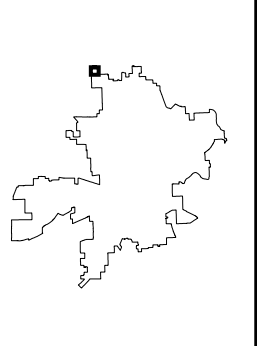

MAP NO.  
**170**  
 6/29/2023

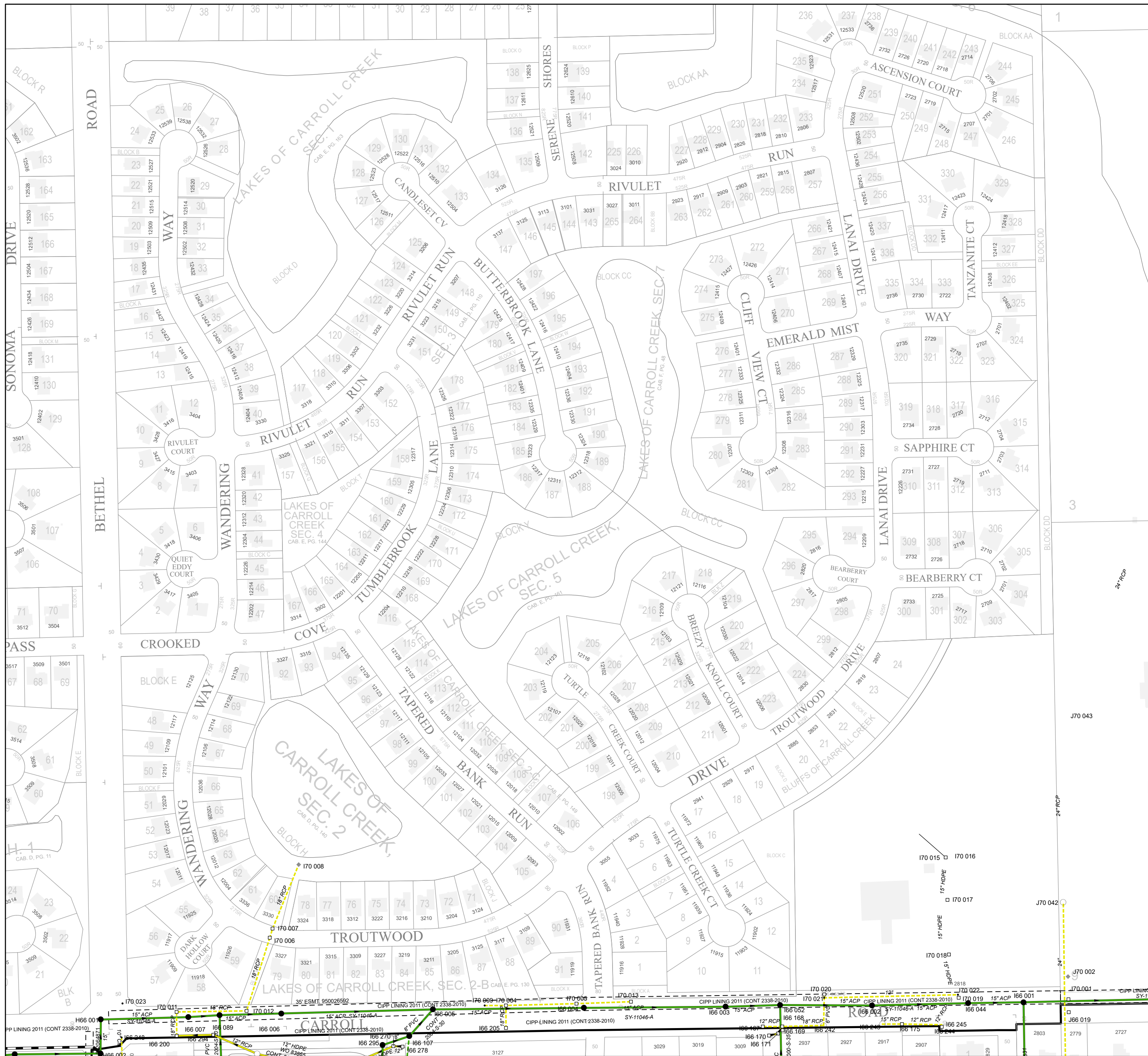

City of Fort Wayne GIS Department logo and contact information.

**LEGEND**

- SEWER / COMBO MANHOLE
- STORM MANHOLE
- ⊗ RETIRED MANHOLE
- CATCH BASIN
- △ INLET
- CLEANOUT
- ⊕ DISCHARGE
- ⊠ GATE VALVE
- ⌒ HEADWALL
- ⌒ HEADWALL W/FLAPGATE
- ⊥ BULKHEAD / PLUG
- PS PUMP STATION
- RI REGULATOR
- ⊖ VALVE PIT
- ⊕ AIR RELEASE VALVE
- ▼ DUCKBILL FLAPGATE

Line styles for pipes:

- SANITARY PIPE
- STORM PIPE
- COMBINED PIPE
- PRESSURIZED MAIN
- PRIVATE MAIN
- RETIRED MAIN

R22 176 STRUCTURE ID  
12345 PROJECT ID

NOTICE: THE INFORMATION DEPICTED ON THIS MAP CONCERNING LOCATION, TYPE, SIZE AND MATERIAL OF UNDERGROUND UTILITIES IS NOT GUARANTEED TO BE ACCURATE OR ALL INCLUSIVE. INFORMATION SHOWN WAS OBTAINED FROM AVAILABLE RECORDS. FIELD INVESTIGATION SHOULD BE CONDUCTED TO DETERMINE ACCURACY.

**CITY OF FORT WAYNE**  
**CITY UTILITIES**  
 CITIZENS SQUARE  
 200 E. BERRY STREET  
 FORT WAYNE, IN 46802

SW 1/4 SEC. 30  
 TOWNSHIP 32 N, RANGE 12 E  
 PERRY TWP, ALLEN CO.  
 MAP SCALE : 1" = 200'

MAP NO.  
**170**  
 6/29/2023