



PRODUCED BY
CITY OF FORT WAYNE
G.I.S. DEPARTMENT

NOTICE: THE INFORMATION
DEPICTED ON THIS MAP
CONCERNING LOCATION,
TYPE, AND SIZE OF STREET
INFRASTRUCTURE IS NOT
GUARANTEED TO BE
ACCURATE OR ALL
INCLUSIVE. INFORMATION
SHOWN WAS OBTAINED
FROM AVAILABLE RECORDS.
FIELD INVESTIGATION
SHOULD BE CONDUCTED TO
DETERMINE ACCURACY.

CITY OF FORT WAYNE
STREET ENGINEERING
CITIZENS SQUARE
200 EAST BERRY STREET
FORT WAYNE, IN 46802

MAP SCALE : 1" = 200'
(PRINT AT 15" X 18" PAGE SIZE)
0 100 200 300 400

Feet

NE 1/4 SEC. 8
TOWNSHIP 30 N, RANGE 13 E
ADAMS TWP, ALLEN CO.

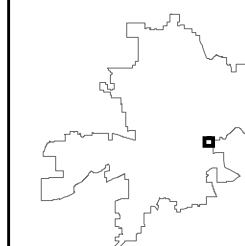

MAP NO.
S02

2/1/2017

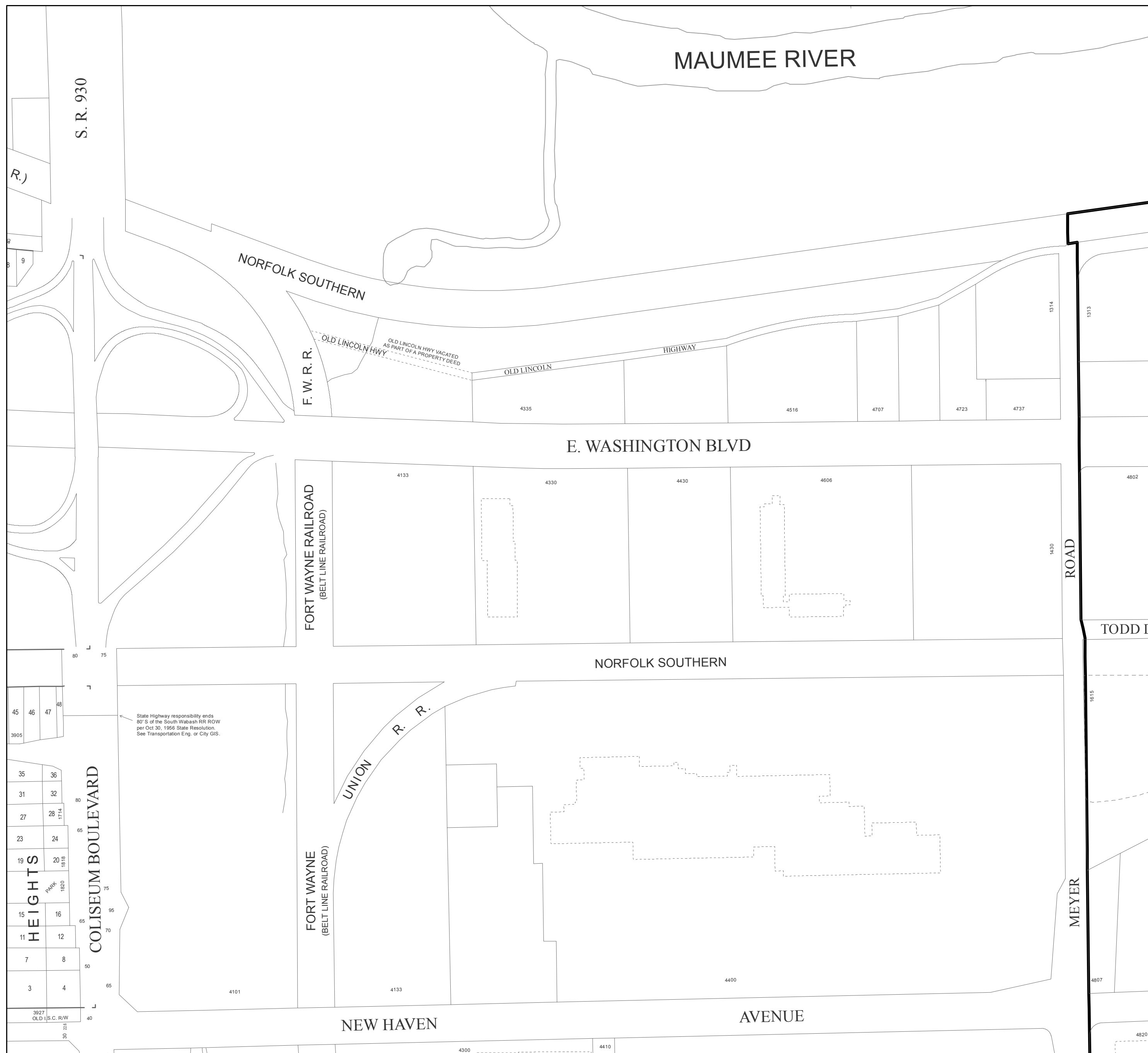

MAUMEE RIVER

S. R. 930

NORFOLK SOUTHERN

F. W. R. R.

OLD LINCOLN HWY
AS PART OF A PROPERTY DEED

OLD LINCOLN

HIGHWAY

E. WASHINGTON BLVD

FORT WAYNE RAILROAD
(BELT LINE RAILROAD)

NORFOLK SOUTHERN

FORT WAYNE
(BELT LINE RAILROAD)

UNION R. R.

ROAD

TODD D

MEYER

NEW HAVEN

AVENUE

State Highway responsibility ends
80' S of the South Wabash RR ROW
per Oct 30, 1956 State Resolution.
See Transportation Eng. or City GIS.

45	46	47	48
3905			
35	36		
31	32		
27	28	1714	
23	24		
19	20	1818	
15	16	1820	
11	12		
7	8		
3	4		
3927			
OLD S.C. R/W			
30	21		

COLISEUM BOULEVARD

R.)

9

8

7

6

5

4

3

2

1

0

9

8

7

6

5

4

3

2

1

0

9

8

7

6

5

4300 4410

1314

1313

4335

4516

4707

4723

4737

4133

4330

4430

4606

4802

1430

1615

4101

4133

4400

4807

4820