



PRODUCED BY  
CITY OF FORT WAYNE  
G.I.S. DEPARTMENT

**LEGEND**

- SEWER / COMBO MANHOLE
- STORM MANHOLE
- ⊗ RETIRED MANHOLE
- △ CATCH BASIN
- INLET
- CLEANOUT
- ⊕ DISCHARGE
- ⊠ GATE VALVE
- ⌒ HEADWALL
- ⌒ HEADWALL w/FLAPGATE
- ⌒ BULKHEAD / PLUG
- PS PUMP STATION
- R REGULATOR
- ⊖ VALVE PIT
- ⊖ AIR RELEASE VALVE
- ▼ DUCKBILL FLAPGATE
- SANITARY PIPE
- STORM PIPE
- COMBINED PIPE
- PRESSURIZED MAIN
- PRIVATE MAIN
- RETIRED MAIN
- R22 176 STRUCTURE ID
- 12345 PROJECT ID

NOTICE: THE INFORMATION DEPICTED ON THIS MAP CONCERNING LOCATION, TYPE, SIZE AND MATERIAL OF UNDERGROUND UTILITIES IS NOT GUARANTEED TO BE ACCURATE OR ALL INCLUSIVE. INFORMATION SHOWN WAS OBTAINED FROM AVAILABLE RECORDS. FIELD INVESTIGATION SHOULD BE CONDUCTED TO DETERMINE ACCURACY.

**CITY OF FORT WAYNE**  
**CITY UTILITIES**  
CITIZENS SQUARE  
200 E. BERRY STREET  
FORT WAYNE, IN 46802

NE 1/4 SEC. 11  
TOWNSHIP 30 N, RANGE 13 E  
ADAMS TWP, ALLEN CO.  
MAP SCALE : 1" = 200'

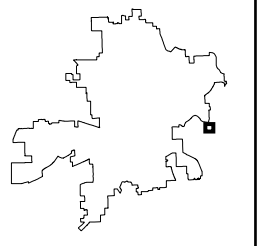

MAP NO.  
**Y02**

4/1/2024

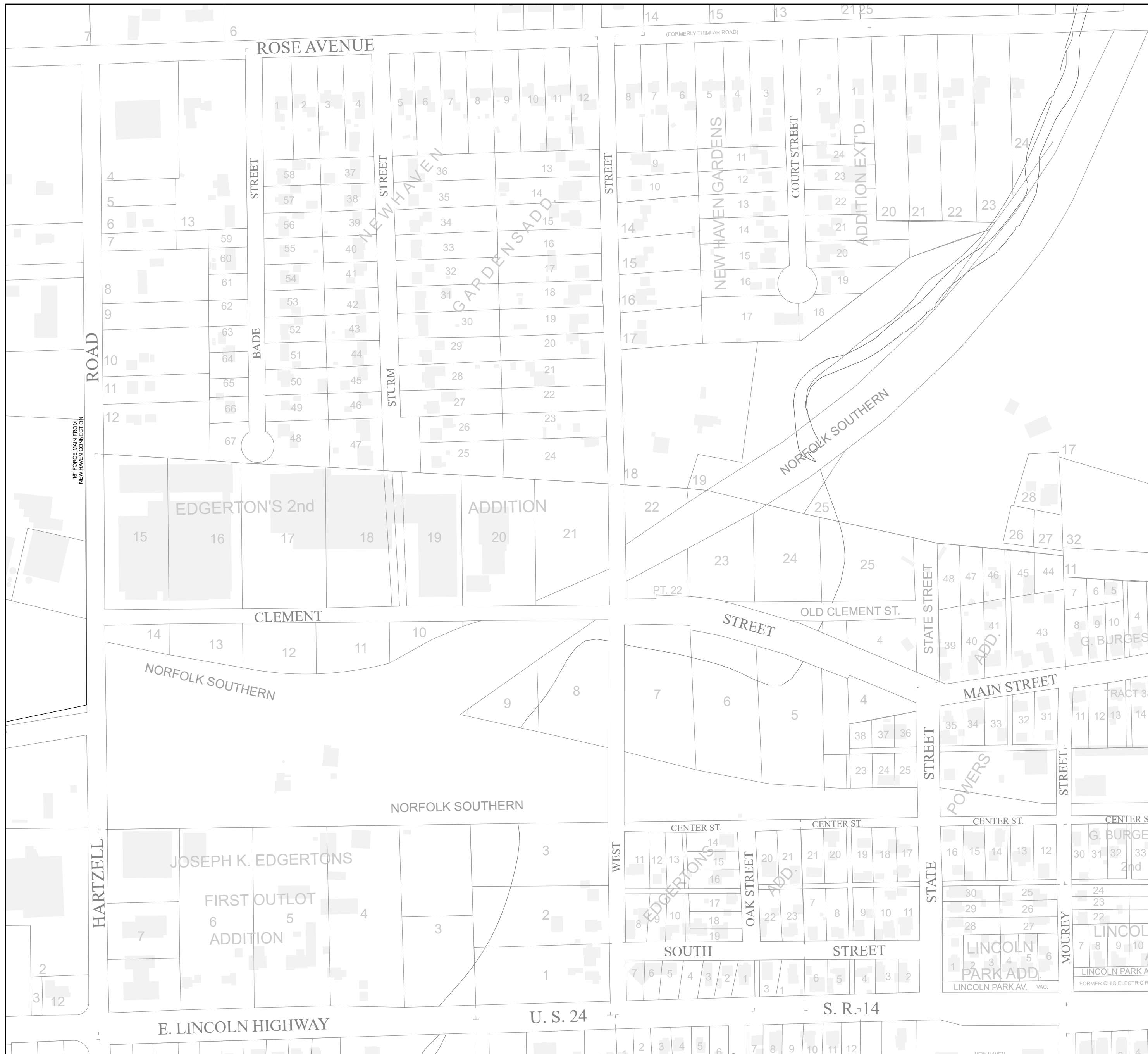

16" FORCE MAIN FROM  
NEW HAVEN CONNECTION

ROAD

HARTZELL

ROSE AVENUE

EDGERTON'S 2nd

ADDITION

CLEMENT

NORFOLK SOUTHERN

NORFOLK SOUTHERN

JOSEPH K. EDGERTONS

FIRST OUTLOT  
ADDITION

E. LINCOLN HIGHWAY

U. S. 24

S. R. 14

(FORMERLY THIMLAR ROAD)

NEW HAVEN GARDENS

COURT STREET

ADDITION EXT'D.

NORFOLK SOUTHERN

STREET

OLD CLEMENT ST.

STATE STREET

MAIN STREET

POWERS

CENTER ST.

CENTER ST.

CENTER ST.

CENTER ST.

WEST

SOUTH

STREET

STATE

LINCOLN  
PARK ADD.

MOUREY

LINCOLN  
PARK AV.

FORMER OHIO ELECTRIC R.