



PRODUCED BY
CITY OF FORT WAYNE
G.I.S. DEPARTMENT

LEGEND

- SEWER / COMBO MANHOLE
- STORM MANHOLE
- ⊙ RETIRED MANHOLE
- CATCH BASIN
- INLET
- CLEANOUT
- ⊕ DISCHARGE
- ⊗ GATE VALVE
- ⌒ HEADWALL
- ⌒ HEADWALL w/FLAPGATE
- ⊥ BULKHEAD / PLUG
- ⊠ PUMP STATION
- ⊠ REGULATOR
- ⊕ VALVE PIT
- ⊕ AIR RELEASE VALVE
- ▼ DUCKBILL FLAPGATE
- SANITARY PIPE
- STORM PIPE
- COMBINED PIPE
- PRESSURIZED MAIN
- PRIVATE MAIN
- RETIRED MAIN
- R22 176 STRUCTURE ID
- 12345 PROJECT ID

NOTICE: THE INFORMATION DEPICTED ON THIS MAP CONCERNING LOCATION, TYPE, SIZE AND MATERIAL OF UNDERGROUND UTILITIES IS NOT GUARANTEED TO BE ACCURATE OR ALL INCLUSIVE. INFORMATION SHOWN WAS OBTAINED FROM AVAILABLE RECORDS. FIELD INVESTIGATION SHOULD BE CONDUCTED TO DETERMINE ACCURACY.

CITY OF FORT WAYNE
CITY UTILITIES
CITIZENS SQUARE
200 E. BERRY STREET
FORT WAYNE, IN 46802

SE 1/4 SEC. 24
TOWNSHIP 30 N, RANGE 12 E
WAYNE TWP, ALLEN CO.
MAP SCALE : 1" = 200'

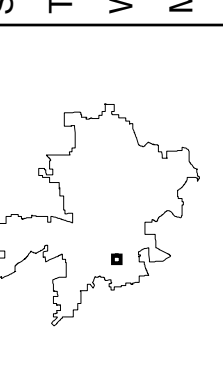

MAP NO.
O19
11/6/2018

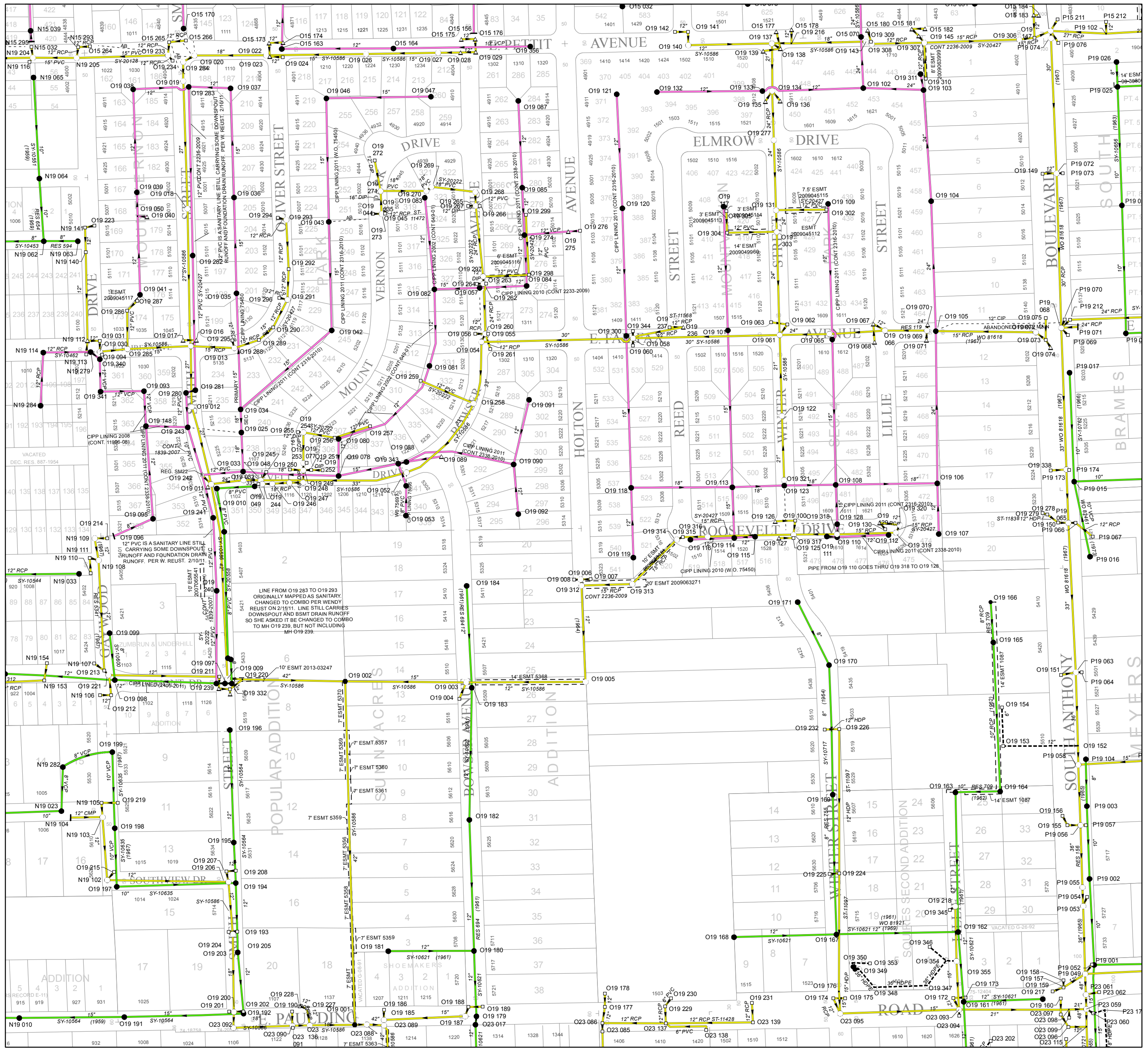

LINE FROM O19 283 TO O19 293
ORIGINALLY MAPPED AS SANITARY
CHANGED TO COMBO PER WENDY
REUST ON 2/11/11. LINE STILL CARRIES
DOWNSPOUT AND BSMT DRAIN RUNOFF
SO SHE ASKED IT BE CHANGED TO COMBO
TO MH O19 239, BUT NOT INCLUDING
MH O19 239.

PIPE FROM O19 110 GOES THRU
O19 318 TO O19 128

20" ESMT 2009063271
CONT 2236-2009

21" P95 539 (1961)

8" RES 708
(1962)

14" ESMT 1087
(1962)

10" RCP (1962)

33" WO 81618 (1967)

10" RCP (1962)

12" RCP

12" RCP

12" RCP

12" RCP

12" RCP

12" RCP

12" RCP

12" RCP

12" RCP

12" RCP

12" RCP

12" RCP

12" RCP

12" RCP

12" RCP

12" RCP

12" RCP

12" RCP

12" RCP

12" RCP

12" RCP

12" RCP

12" RCP

12" RCP

12" RCP

12" RCP

12" RCP

12" RCP

12" RCP

12" RCP

12" RCP

12" RCP

12" RCP

12" RCP

12" RCP

12" RCP

12" RCP

12" RCP

12" RCP

12" RCP

12" RCP

12" RCP

12" RCP

12" RCP

12" RCP

12" RCP

12" RCP

12" RCP

12" RCP

12" RCP

12" RCP

12" RCP

12" RCP

12" RCP

12" RCP

12" RCP

12" RCP

12" RCP

12" RCP

12" RCP

12" RCP

12" RCP

12" RCP

12" RCP

12" RCP

12" RCP

12" RCP

12" RCP

12" RCP

12" RCP

12" RCP

12" RCP

12" RCP

12" RCP

12" RCP

12" RCP

12" RCP

12" RCP

12" RCP

12" RCP

12" RCP

12" RCP

12" RCP

12" RCP

12" RCP

12" RCP

12" RCP

12" RCP

12" RCP

12" RCP

12" RCP

12" RCP

12" RCP

12" RCP

12" RCP

12" RCP

12" RCP

12" RCP

12" RCP

12" RCP

12" RCP

12" RCP

12" RCP

12" RCP

12" RCP

12" RCP

12" RCP

12" RCP

12" RCP

12" RCP

12" RCP

12" RCP

12" RCP

12" RCP

12" RCP

12" RCP

12" RCP

12" RCP

12" RCP

12" RCP

12" RCP

12" RCP

12" RCP

12" RCP

12" RCP

12" RCP

12" RCP

12" RCP

12" RCP

12" RCP

12" RCP

12" RCP

12" RCP

12" RCP

12" RCP

12" RCP

12" RCP

12" RCP

12" RCP

12" RCP

12" RCP

12" RCP

12" RCP

12" RCP

12" RCP

12" RCP

12" RCP

12" RCP

12" RCP

12" RCP

12" RCP

12" RCP

12" RCP

12" RCP

12" RCP

12" RCP

12" RCP

12" RCP

12" RCP

12" RCP

12" RCP

12" RCP

12" RCP

12" RCP

12" RCP

12" RCP

12" RCP

12" RCP

12" RCP

12" RCP

12" RCP

12" RCP

12" RCP

12" RCP

12" RCP

12" RCP

12" RCP

12" RCP