



PRODUCED BY
CITY OF FORT WAYNE
G.I.S. DEPARTMENT

LEGEND

- SEWER / COMBO MANHOLE
- STORM MANHOLE
- ⊗ RETIRED MANHOLE
- CATCH BASIN
- △ INLET
- CLEANOUT
- ⊕ DISCHARGE
- ⊗ GATE VALVE
- ⌒ HEADWALL
- ⌒ HEADWALL W/FLAPGATE
- ⊥ BULKHEAD / PLUG
- ⊡ PUMP STATION
- ⊡ REGULATOR
- ⊕ VALVE PIT
- ⊕ AIR VALVE
- ▼ DUCKBILL FLAPGATE
- SANITARY PIPE
- STORM PIPE
- COMBINED PIPE
- PRESSURIZED MAIN
- PRIVATE MAIN
- RETIRED MAIN

R22 176 STRUCTURE ID
12345 PROJECT ID

NOTICE: THE INFORMATION DEPICTED ON THIS MAP CONCERNING LOCATION, TYPE, SIZE AND MATERIAL OF UNDERGROUND UTILITIES IS NOT GUARANTEED TO BE ACCURATE OR ALL INCLUSIVE. INFORMATION SHOWN WAS OBTAINED FROM AVAILABLE RECORDS. FIELD INVESTIGATION SHOULD BE CONDUCTED TO DETERMINE ACCURACY.

CITY OF FORT WAYNE
CITY UTILITIES
CITIZENS SQUARE
200 E. BERRY STREET
FORT WAYNE, IN 46802

SE 1/4 SEC. 15
TOWNSHIP 30 N, RANGE 12 E
WAYNE TWP, ALLEN CO.
MAP SCALE : 1" = 200'

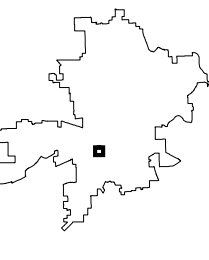

MAP NO.
K11
10/12/2018

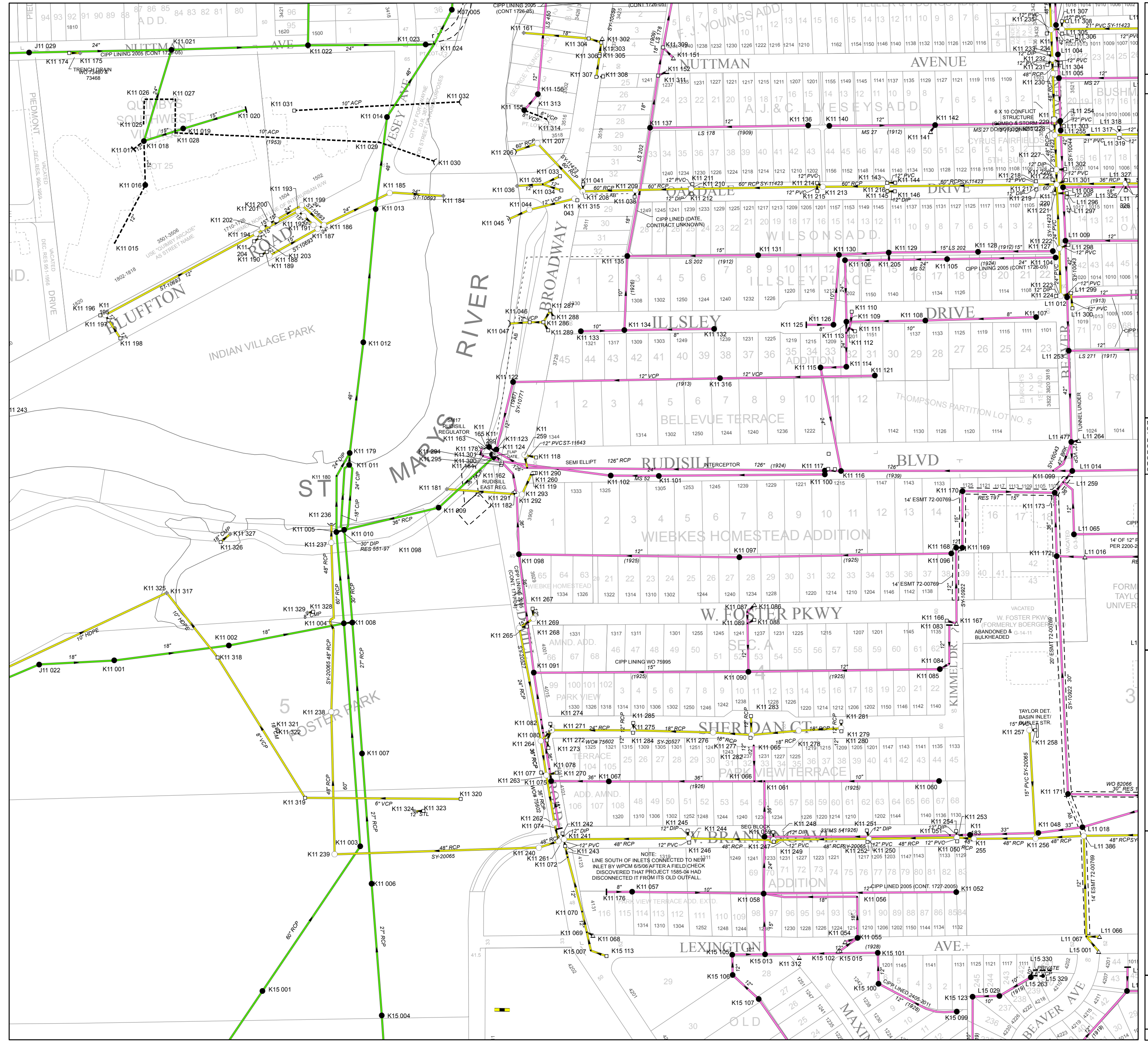

NOTE: 1318
INLET BY WPCM 6/5/06 AFTER A FIELD CHECK
DISCOVERED THAT PROJECT 1585-04 HAD
DISCONNECTED IT FROM ITS OLD OUTFALL.